

2005- MAZDASPEED6 4 CYL. 2.3L TURBOCHARGED AWD

Warning: When working on, under, or around any vehicle exercise caution. Please allow the vehicle's exhaust system to cool before removal, as exhaust system temperatures may cause severe burns. If working without a lift, always consult vehicle manual for correct lifting specifications. Always wear safety glasses and ensure a safe work area. Serious injury or death could occur if safety measures are not followed.

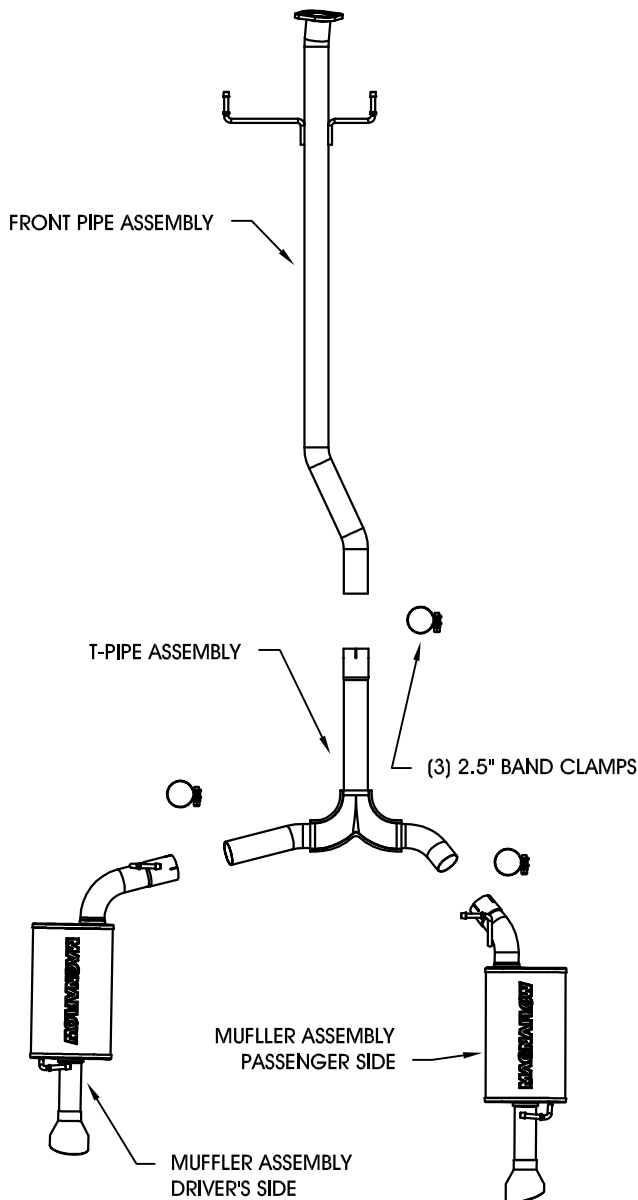

Step 1: (Carefully read all instructions before installation) Disconnect the vehicle's battery before removal of the OEM exhaust. This will allow the computer to reset itself with the new system, and prevent electrical accidents. Begin removing the OEM exhaust system by unbolting the 2-bolt flange at the catalytic converter (Do not discard the OEM fasteners or damage the OEM rubber insulators as they will be reused to mount the new system). Unbolt the mufflers at the 2-bolt flanges and disengage the welded hangers from the rubber insulators to remove the OEM exhaust system. You will also need to remove the chrome-plated "exhaust tips" from the OEM bumper.

Step 2: Begin installation of the new system by bolting the new front pipe assembly to the catalytic converter using the OEM fasteners, and by engaging the hangers into the OEM rubber insulators (Leave all clamps and fasteners loose for final adjustment of the complete system). Install the T-pipe assembly by fastening it to the front pipe using a supplied 2.5" clamp. Install the muffler assemblies in a similar fashion.

Step 3: With all components mounted loosely, adjust the system for overall aesthetics and clearance of frame & bodywork. MAGNAFLOW recommends at least 1/2" of clearance between the exhaust system and any body panels to prevent heat-related body damage or fire, however, the Magnaflow tips may need a closer fit to the OEM bumper.

Step 4: Once a final position has been chosen for the new system, evenly tighten all fasteners from front to rear. The supplied band clamps must be VERY tight to properly align the pipes and prevent leaks (Approximately 65ft-lbs). U-bolt clamps should be tightened to approximately 30-35ft-lbs. Inspect all fasteners after 25-50 miles of operation and retighten if necessary. The exhaust tip location should also be checked and adjusted if necessary to prevent damage to the bumper.

*MAGNAFLOW Performance Exhaust recommends professional installation on all their products

Technical support: 1-800-959-9226 ext. 4500

MAGNAFLOW Performance Exhaust - 22961 Arroyo Vista - Rancho Santa Margarita, CA 92688