

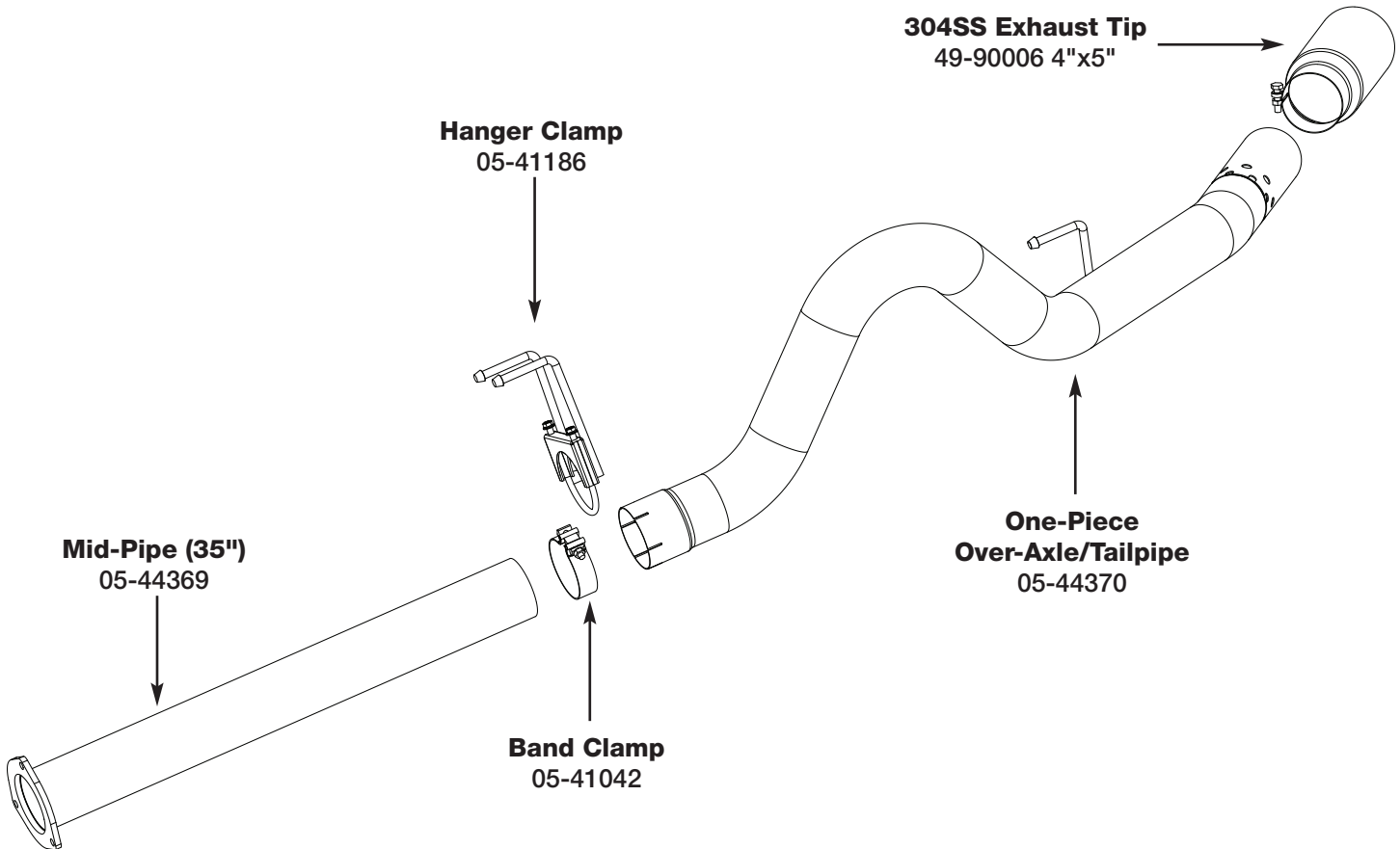

INSTALLATION INSTRUCTIONS

MAKE: FORD
MODEL: SUPER DUTY
YEAR: 2011
ENGINE: V8-6.7L (td)
WHEELBASE: 137" - 172.4"

DPF-Back
49-13028 (409SS)



Step 1: (Read Instructions prior to installation) Remove your stock exhaust from the rear of your truck working your way forward. The spare tire and heat shield will need to be removed for exhaust replacement. Take caution not to damage the factory isolation mounts as they will be reused. ***It is recommended to not fully tighten the clamps until the entire system has been installed.***

Step 2: For ease of installation spread the pieces of the exhaust along side of your vehicle according to the diagram shown above.

Step 3: Install over-axle/tailpipe, using the factory isolation mounts. Now slip the middle hanger clamp and band clamp over the front end of over axle/tailpipe.

Step 4: Install the mid-pipe, test fit first as the mid-pipe will require cutting at the end opposite of the flange to fit shorter wheelbases. Use supplied hardware to attach.

Step 5: Install the exhaust tip making sure not to cover the vent hole. Tighten all connections, re-install the spare tire and heat shield. Adjust for alignment and tighten all connections. Your installation is now complete. It is recommended to re-tighten all exhaust components after the first 50-100 miles.

NOTE :

- aFe recommends that the tailpipe be at least **1/2"-1"** away from any body panels to avoid heat related body damage. **Tighten and secure.**

Caution: Allow time for your vehicle to cool down prior to installation. When working on or under your vehicle proceed with caution. Exhaust systems reach high temperatures and may cause serious burns. Wear protective safety equipment; eye goggles and gloves to ensure a safe installation. **aFe recommends professional installation on our products.**