

Rally Armor 2008+ Mitsubishi Lancer Evolution X Mud Flap Mounting Instructions

Please read the instructions thoroughly before attempting to install mud flaps. Rally Armor always recommends professional installation. For high resolution images and the most up to date instructions please visit our mounting instructions area on <http://www.rallyarmor.com>

To protect and extend the life of your rally mud flap set care must be taken during parking and reversing.

Your mud flap set contains 4 flaps total for all four tires of the vehicle. Front flaps (4 mounting holes) – Rear flaps (3 mounting holes).

Your mounting hardware has been checked at our facilities. It consists of:

Quantity	Hardware Item	Item ID
12	Polygon Edge Clips	PolCI
16	Washers	Wash
8	Short Stainless Steel Screws	ISS
8	Long Stainless Steel Screws	1.5SS
2	Plastic Inserts (fender liner)	Ins
2	Plastic Inserts (Bracket)	Ins2
2	"L" Brackets (rear flaps)	Lbrkt
2	Short "L" Brackets (front flaps)	Lbrkt2

Recommended Tools: Short Phillips Screwdriver; Offset/Ratcheting Phillips; Flat head Screwdriver; Marker; Metal Pick

Front Mud Flap Installation

1. Begin by parking the vehicle on an even surface. Turn the steering wheel towards the side you are working on to gain access to the wheel well area.
2. Remove the 3 wheel well fasteners (#1-3) that secure the fender liner to the vehicle. To remove the fasteners, pop the inner tab out of the assembly first then remove the complete assembly by prying the outer edges of the fastener (Figure A).
3. Pull fender liner away from the body of the vehicle and position 2 polygon clips (PolCI), as shown, over mounting points 1 and 2 (Figure B). Reinstall liner over the clips.
4. From under the vehicle remove the factory screw temporarily; this screw will be reinstalled. The factory screw connects the front inner side skirt area to the body of the vehicle (Figure C).

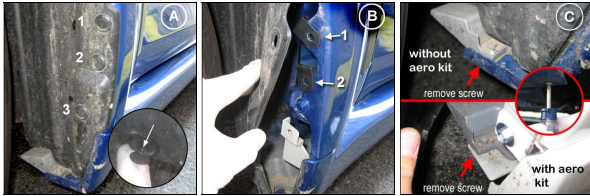

5. Place insert for bracket (Ins2) flush into larger hole A of the short L mounting bracket. Slide bracket into side skirt area and align hole B to corresponding hole on the side skirt (Figure D).
6. Secure the bracket to the vehicle in the area where the factory screw was removed to hole B on the bracket. Remount factory screw previously removed and leave slightly loose for adjustment. Position assembled bracket as pictured (Figure E).
7. Match front mud flap against the vehicle mounting points (#1-3) with logo facing the rear of the vehicle. Place a long (1.5SS) screw through a washer (Wash) and loosely thread mounting points #1 and #2. Step away from the vehicle and **adjust mud flap until perpendicular to the ground.** **Tip: On non-Aero kit EVOs slide bracket behind stock skirt lip.**
8. With a marker mark the center of mounting hole #4 (Figure F). Remove mud flap.

▲ **Tip: Experienced installers can hold and place mud flap against vehicle and mark hole # 4 without having to thread points #1 and #2.**



9. To create mounting point #4, locate the center of your mark as a guide and place sharp tip of short screw (1SS) against the side of the liner facing the tire with Phillips screwdriver. Place hand behind the liner and perform a few firm turns to pierce the liner as shown (Figure G). Turn screw until the tip is **just visible** on the liner side facing the rear of the vehicle then remove screw.

10. Place front mud flap with logo facing the rear of the vehicle. Align mud flap holes with their corresponding mounting slots on the vehicle.

Using a short screw (1SS) through a washer (Wash) through mounting point #4 on the mud flap, place an insert (Ins) over the tip of the screw and hold against the body of the liner while continuing to turn screw making sure that the insert is flush against the liner (Figure H). Replace liner with mud flap back against vehicle as previously installed. ***Do not fully tighten.*** You will adjust the mud flap before final bolting.

11. Using a long screw (1.5SS) through a washer (Wash) thread mounting points #1 and #2 through mud flap. Using a short screw (1SS) through a washer (Wash) thread mounting point #5 on short L bracket. ***Do not fully tighten.*** You will adjust the mud flap before tightening.

12. Replace factory fastener #3 removed previously (Figure I).

13. Align mud flaps by walking away to view the mud flap from the rear of the vehicle. Confirm the edges of the flap are **perpendicular to the ground**. If needed, make slight adjustments by shifting the upper/lower portions of the flap. Check each adjustment by walking away from the vehicle and assessing the mud flap in relation to the ground and the body of the vehicle. When flap is **correctly aligned**, tighten all hardware only until snug.

14. Repeat the instructions for the other side of the vehicle to complete front mud flap installation.

▲ **Tip: The hardware is quite strong and self threading but over-tightening the clips beyond their limit is not recommended.**

▲ **Tip: To check any non standard wheel clearance, turn the steering wheel from lock to lock while viewing the wheel well area at different intervals.**



Rear Mud Flap Installation

▲ **Tip: Although removal of the rear tire can ease installation, removal is not necessary. The installation can be completed using an offset screwdriver and jacking up the rear of the vehicle thereby lowering the wheel and facilitating access to the area for easier installation.**

1. Remove the two outer factory fasteners #1 and #2 by unscrewing the inner snap and prying the outer assembly off the bumper. Fastener #3 is removed by prying out the inner tab first then removing the outer assembly (Figure J).

2. From under the rear bumper of the vehicle, remove the factory clip connecting the lower portion of the liner to the rear bumper (Figure K).

3. Place polygon clips over the rear mounting points #1 and #2 then replace liner (Figure L).

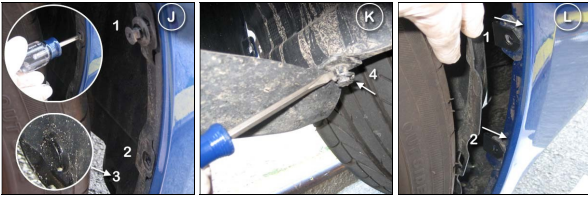

4. Working from under the rear of the vehicle, place a polygon clip over lower liner portion of mounting point #4. Position polygon clip over slotted mounting point B on rear L bracket to create mounting point #5.
5. Place a short screw (1S5) through a washer (Wash) through hole A on rear L bracket (Figure M) then mount rear L bracket assembly to vehicle leaving it slightly loose in order to align the bracket with mud flap later on in the rear installation (Figure N).
6. Reinstall factory fastener #3 (Figure O).

▲ Tip: The hardware is quite strong and self threading but over-tightening the clips beyond their limit is not recommended.



7. Place rear mud flap with logo facing the rear of the vehicle with the outer mounting holes on the mud flap aligned to the corresponding points on the vehicle. Thread long screws (1.555) through washers through rear mounting points #1 and #2. ***Do not fully tighten.*** Adjust the mud flap before tightening the screws (Figure P).
8. Mount the final inner mounting point #5 to L bracket by threading 1 short screw (1S5) through a washer (Wash) through the polygon clip that was placed on point B on L bracket (tip may also thread into liner) ***Do not fully tighten.***

Tip: You may need to apply pressure or loosen the clip to adjust the bracket from the rear to complete installation (Figure Q).

9. Confirm the edge of the flap is **perpendicular to the ground**. If needed, make slight adjustments by shifting the upper or lower portions of the flap. Check each incremental adjustment by walking away from the vehicle and looking at the mud flap directly behind in relation to the ground and the body of the vehicle. When flap is **correctly aligned**, tighten hardware **only until snug** (Figure R).



10. Repeat the instructions for the other side of the vehicle to complete rear mud flap installation.

For X model/Station P, Version 1.0, #1.2008